

SP-3475 SUB φ

Application to Register a Renewable Energy Facility or New Renewable Energy Facility Pursuant to Rule R8-66

(Applicants should consult Rule R8-66 while completing this form in order to ensure they provide sufficient information.)

OFFICIAL COPY
Apr 23 2014

Facility name:	Innovative Solar 34
Full and correct name of the owner of the facility:	Innovative Solar 34, LLC
Business address:	171 Rolling Meadows Rd. Fletcher, NC 28732
Electronic mailing address:	rhgreen@aol.com
Telephone number:	828-215-9064
Owner's agent for purposes of this application, if applicable:	Richard Green, Member/Manager
Agent's business address:	91 Distant View Dr. Asheville, NC 28803
Agent's electronic mailing address:	rhgreen@aol.com
Agent's telephone number:	828-777-0052
The owner is:	<input type="checkbox"/> Individual <input type="checkbox"/> Partnership <input checked="" type="checkbox"/> Corporation (including LLC)
If a corporation, state and date of incorporation.	State __NC Date 8/14/13

<p>If a corporation that is incorporated outside of North Carolina, is it domesticated in North Carolina?</p>	<p><input type="checkbox"/> Yes <input checked="" type="checkbox"/> <u>N/A</u> <input type="checkbox"/> No</p>
<p>If a partnership, the name and business address of each general partner. (Add additional sheets if necessary.)</p>	<p>N/A</p>
<p>Nature of the renewable energy facility:</p> <p>1. Describe the facility, including its technology, and the source of its power and fuel(s). Thermal facilities should describe how its host uses the facility's thermal energy output. (Add additional sheets if necessary.)</p> <p>2. Whether it produces electricity, useful thermal energy, or both.</p> <p>3. Nameplate capacity in kW/MW (AC) and/or maximum Btu per hour for thermal facilities.</p>	<p>The generating facility consists of a 50.00 Mw AC solar photovoltaic ground mounted solar farm. There will be multiple ground mounted racks providing electricity to the power grid.</p> <p>Electricity</p> <p>50.00 Mw</p>

<p>The location of the facility set forth in terms of local highways, streets, rivers, streams, or other generally known local landmarks. Attach a map, such as a county road map, with the location indicated on the map.</p>	<p>Currie Rd. at Derby Rd. Jackson Springs, NC 27281 Richmond County (see attached map)</p>
<p>Site ownership:</p>	
<p>1. Is the site owner other than the facility owner? If yes, who is the site owner?</p>	<p>Yes. The site owner is Robert L. Currie, Jr., William O. Currie, John A. Currie and Nancy Elizabeth C. Pittman.</p>
<p>2. What is the facility owner's legal interest in the site?</p>	<p>The facility owner will be ground leasing the property on a long term land lease.</p>
<p>List the approvals that are required to build and/or operate this facility, and attach copies of those that have been obtained. Wind facilities with multiple turbines, where each turbine is licensed separately, may provide copies of approvals for one such turbine but shall add an attestation that approvals for all of the turbines are available for inspection.</p>	
<p>1. Federal permits and licenses:</p>	<p>The owner has filed Form 556 as a Self-Certification notice as a QF to the FERC under Docket No. QF 13-581-001.</p>
<p>2. State permits and licenses:</p>	<p>Erosion sediment Control & Storm Water permits will apply. Wetlands, Riparian Buffer, and Endangered/Threatened Species may apply.</p>
<p>3. Exemptions required for construction and operation of the facility:</p>	<p>N/A</p>
<p>4. Statement of whether each has been obtained or applied for (attach copy of those that have been obtained with this application):</p>	<p>Permits and approvals have not yet been applied for.</p>

If the facility has been placed into service, on what date did the facility begin operating?	The facility has not yet been placed in service.
If the facility is not yet operating, on what date is the facility projected to be placed into service?	November 1, 2015
If the facility is already operating, what is the amount of energy produced by the facility, net of station use, for the most recent 12-month or calendar-year period? Energy production data for a shorter time period is acceptable for facilities that have not yet operated for a full year.	The facility is not yet operating.
What entity does (or will) read the facility's energy production meter(s) for the purpose of issuing renewable energy certificates?	Duke Energy
For thermal energy facilities, describe the method to be used to determine the facility's thermal energy production, in BTUs, that is eligible for REC issuance.	N/A
Does the facility participate in a REC tracking system and if so, which one? If not, which tracking system will the facility participate in for the purpose of REC issuance?	No. NC-RETS.
If this facility has already been the subject of a proceeding or submittal before the Commission,	SP - 3475 Sub 0

<p>such as a Report of Proposed Construction or a Certificate of Public Convenience and Necessity, please provide the Commission Docket Number, if available.</p>	
---	--

The owner of the renewable energy facility shall provide the following attestations, signed and notarized:

1. ☒ Yes ☐ No I certify that the facility is in substantial compliance with all federal and state laws, regulations, and rules for the protection of the environment and conservation of natural resources.
2. ☒ Yes ☐ No I certify that the facility satisfies the requirements of G.S. 62-133.8(a)(5) or (7) as a:
☐ renewable energy facility, or
☒ new renewable energy facility,
 and that the facility will be operated as a:
☐ renewable energy facility, or
☒ new renewable energy facility.
3. ☒ Yes ☐ No I certify that 1) my organization is not simultaneously under contract with NC GreenPower to sell our RECs emanating from the same electricity production being tracked in NC-RETS; and 2) any renewable energy certificates (whether or not bundled with electric power) sold to an electric power supplier to comply with G.S. 62-133.8 have not, and will not, be remarketed or otherwise resold for any other purpose, including another renewable energy portfolio standard or voluntary purchase of renewable energy certificates in North Carolina (such as NC GreenPower) or any other state or country, and that the electric power associated with the certificates will not be offered or sold with any representation that the power is bundled with renewable energy certificates.
4. ☒ Yes ☐ No I certify that I consent to the auditing of my organization's books and records by the Public Staff insofar as those records relate to transactions with North Carolina electric power suppliers, and agree to provide the Public Staff and the Commission access to our books and records, wherever they are located, and to the facility.
5. ☒ Yes ☐ No I certify that the information provided is true and correct for all years that the facility has earned RECs for compliance with G.S. 62-133.8.
6. ☒ Yes ☐ No I certify that I am the owner of the renewable energy facility or am duly authorized to act on behalf of the owner for the purpose of this filing.

Richard H. Green
 (Signature)

RICHARD H. GREEN
 (Name - Printed or Typed)

MEMBER/MANAGER
 (Title)

4/21/14
 (Date)

VERIFICATION

STATE OF NORTH CAROLINA COUNTY OF Buncombe

Richard A. Green, personally appeared before me this day and, being first duly sworn, says that the facts stated in the foregoing application and any exhibits, documents, and statements thereto attached are true as he or she believes.

WITNESS my hand and notarial seal, this 21st day of April, 2014.

My Commission Expires: 6-13-2015

Theresa Hyder D'Amore
Signature of Notary Public

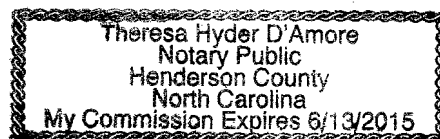

Theresa Hyder D'Amore
Name of Notary Public – Typed or Printed

The name of the person who completes and signs the application must be typed or printed by the notary in the space provided in the verification. The notary's name must be typed or printed below the notary's seal. This original verification must be affixed to the original application, and a copy of this verification must be affixed to each of the 10 copies that are also submitted to the Commission.

CURRIE PROPERTY

SOLAR LEASE

EXHIBIT A

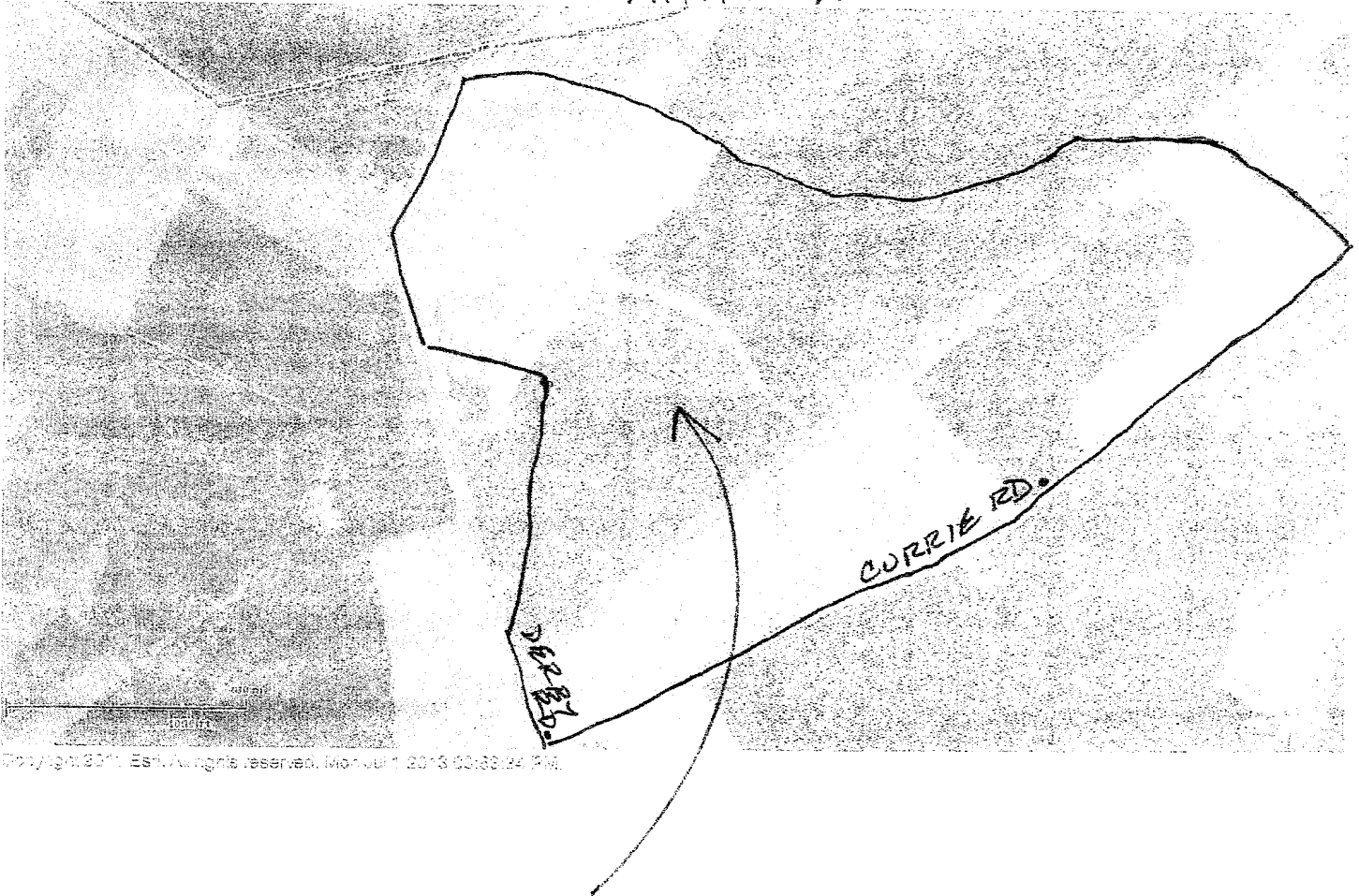

PROPOSED 226 ACRE SOLAR FARM
RICHMOND COUNTY
PARCEL # 851100116602

LATITUDE

35.153916

LONGITUDE

-79.631788

CURRIE RD. AT DERBY RD.
JACKSON SPRINGS, NC. 27281