

RET-8, sub 20

FILED

NOV 14 2011

Clerk's Office
N.C. Utility Facility Commission

Application to Register a Renewable Energy Facility or New Renewable Energy Facility

Facility name:	Hampton Inn, Hendersonville
Full and correct name of the owner of the facility:	FLS Owner II, LLC
Business address:	239 Amboy Road, Asheville, NC 28806
Electronic mailing address:	nadine@flsenergy.com
Telephone number:	828-350-3993
Owner's agent for purposes of this application, if applicable:	
Agent's business address:	
Agent's electronic mailing address:	
Agent's telephone number:	
The owner is:	<input type="checkbox"/> Individual <input type="checkbox"/> Partnership <input checked="" type="checkbox"/> Corporation (including LLC)
If a corporation, state and date of incorporation.	State <u>North Carolina</u> Date <u>December 28, 2009</u>
If a corporation that is incorporated outside of North Carolina, is it domesticated in North Carolina?	<input type="checkbox"/> Yes <input type="checkbox"/> No

OFFICIAL COPY

AM standard dist

<p>If a partnership, the name and business address of each general partner. (Add additional sheets if necessary.)</p>	
<p>Nature of the renewable energy facility:</p>	
<p>1. Technology, including the source of its power or fuel(s).</p>	<p>24 roof mounted panels</p>
<p>2. Whether it produces electricity, useful thermal energy, or both.</p>	<p>Solar thermal energy</p>
<p>3. Nameplate capacity in kW/MW (AC) or maximum Btu per hour for thermal facilities.</p>	<p>32,000 Btus per hour</p>
<p>The location of the facility set forth in terms of local highways, streets, rivers, streams, or other generally known local landmarks. Attach a map, such as a county road map, with the location indicated on the map.</p>	<p>155 Sugarloaf Road, Hendersonville, NC 28792 Map is at end of document</p>
<p>Site ownership:</p>	
<p>1. Is the site owner other than the facility owner? If yes, who is the site owner?</p>	<p>Site owner is The Hotel Group dba Hampton Inn Hendersonville</p>
<p>2. What is the facility owner's interest in the site?</p>	<p>Facility owner is leasing the site from the site owner.</p>

List the approvals that are required to build and/or operate this facility, and attach copies of those that have been obtained. Wind facilities with multiple turbines, where each turbine is licensed separately, may provide copies of approvals for one such turbine but shall add an attestation that approvals for all of the turbines are available for inspection.

1. Federal permits and licenses:	
2. State permits and licenses:	
3. Exemptions required for construction and operation of the facility:	
4. Statement of whether each has been obtained or applied for (attach copy of those that have been obtained with this application):	
If the facility has been placed into service, on what date did the facility begin operating?	
If the facility is not yet operating, on what date is the facility projected to be placed into service?	December 2011

<p>If the facility is already operating, what is the amount of energy produced by the facility, net of station use, for the most recent 12-month or calendar-year period? Energy production data for a shorter time period is acceptable for facilities that have not yet operated for a full year.</p>	
<p>What entity does (or will) read the facility's energy production meter(s) for the purpose of issuing renewable energy certificates?</p>	<p>FLS Energy, Inc.</p>
<p>Does the facility participate in a REC tracking system and if so, which one? If not, which tracking system will the facility participate in for the purpose of REC issuance?</p>	<p>Yes. NC-RETS</p>
<p>If this facility has already been the subject of a proceeding or submittal before the Commission, such as a Report of Proposed Construction or a Certificate of Public Convenience and Necessity, please provide the Commission Docket Number, if available.</p>	

The owner of the renewable energy facility shall provide the following attestations, signed and notarized:

1. Yes No I certify that the facility is in substantial compliance with all federal and state laws, regulations, and rules for the protection of the environment and conservation of natural resources.

2. Yes No I certify that the facility satisfies the requirements of G.S. 62-133.8(a)(5) or (7) as a:
_____ renewable energy facility, or
 new renewable energy facility,
and that the facility will be operated as a:
_____ renewable energy facility, or
 new renewable energy facility.

3. Yes No I certify that 1) my organization is not simultaneously under contract with NC GreenPower to sell our RECs emanating from the same electricity production being tracked in NC-RETS; and 2) any renewable energy certificates (whether or not bundled with electric power) sold to an electric power supplier to comply with G.S. 62-133.8 have not, and will not, be remarketed or otherwise resold for any other purpose, including another renewable energy portfolio standard or voluntary purchase of renewable energy certificates in North Carolina (such as NC GreenPower) or any other state or country, and that the electric power associated with the certificates will not be offered or sold with any representation that the power is bundled with renewable energy certificates.

4. Yes No I certify that I consent to the auditing of my organization's books and records by the Public Staff insofar as those records relate to transactions with North Carolina electric power suppliers, and agree to provide the Public Staff and the Commission access to our books and records, wherever they are located, and to the facility.

5. Yes No I certify that I am the owner of the renewable energy facility or am duly authorized to act on behalf of the owner for the purpose of this filing.



(Signature)

Michael Shore

(Name - Printed or Typed)

CEO, Managing Member

(Title)

11-10-2011

(Date)

VERIFICATION

STATE OF North Carolina COUNTY OF Buncombe

Michael Shore, personally appeared before me this day and, being first duly sworn, says that the facts stated in the foregoing application and any exhibits, documents, and statements thereto attached are true as he or she believes.

WITNESS my hand and notarial seal, this 10th day of November, 2011.

Nadine A Hamby
Signature of Notary Public

Nadine A Hamby
Name of Notary Public (Typed or Printed)

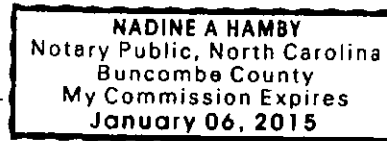

1-6-2015
Commission expiration date

The name of the person who completes and signs the application must be typed or printed by the notary in the space provided in the verification. The notary's name must be typed or printed below the notary's seal. This original verification must be affixed to the original application, and a copy of this verification must be affixed to each of the 15 copies that are also submitted to the Commission.

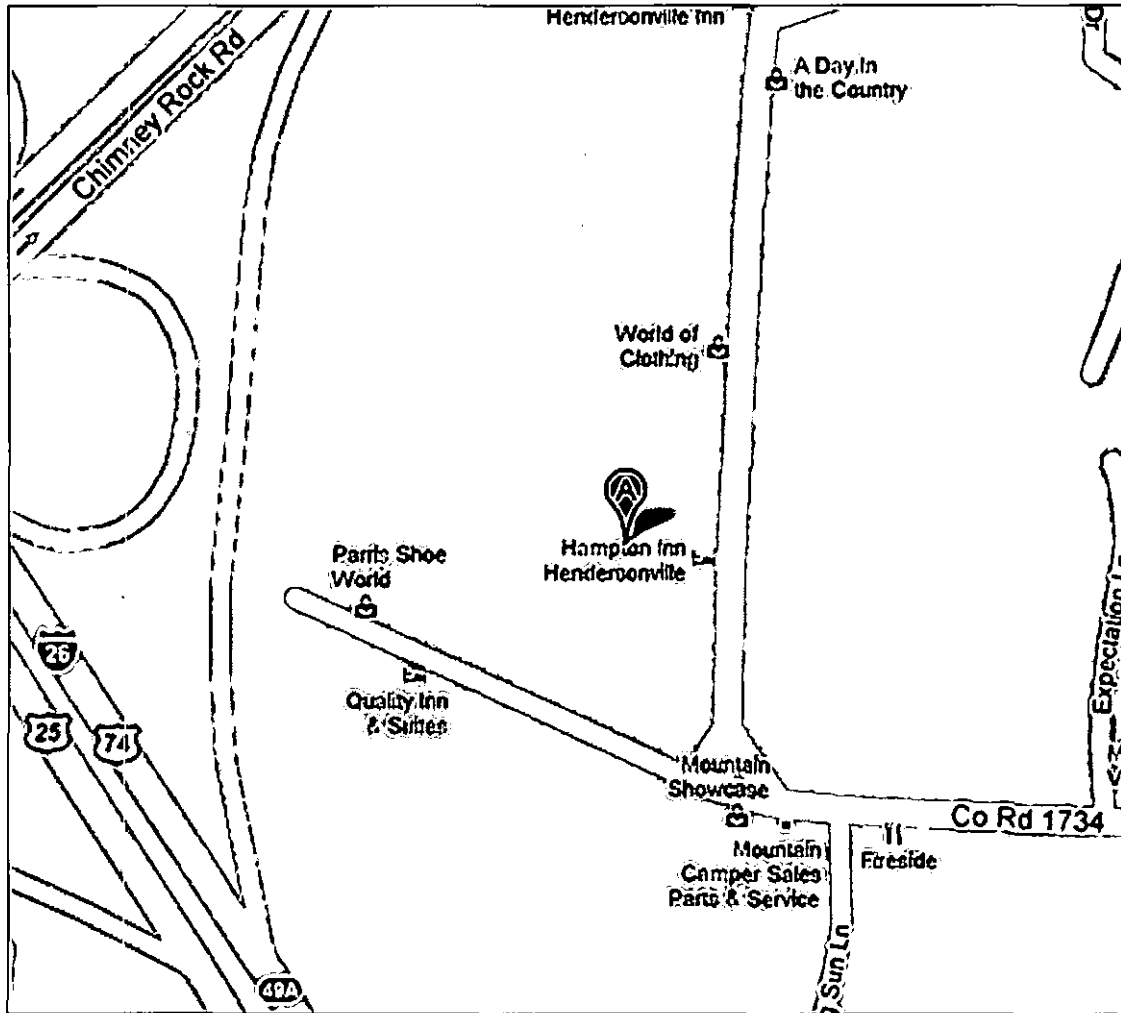

Hampton Inn Hendersonville
155 Sugarloaf Road
Hendersonville, NC 28792