

ROPC Amendment for SP-20879 Sub 0

Line 3 III – Changed System size to 300 kW

DOCKET NO. SP 20879 SUB 0 & EGL-1 SUB 1

Filing Fee Tendered \$ 50.00

Report of Proposed Construction (RPC) – Commission Rule R8-65

Pursuant to G.S. 62-110.1(g), any person who seeks to construct an electric generating facility in North Carolina, and is exempt from the requirement to obtain a certificate of public convenience and necessity, is required to file this form and a notice of completion of the construction of the facility. This form may be accompanied by any exhibits or additional responses incorporated by reference thereto and attached to this form. This form must be accompanied by the required filing fee of \$50.00.

This form may be electronically filed. Please see www.ncuc.net for instructions.

If this form is filed by hard copy, the original plus 6 copies must be presented at or transmitted to the office of the Chief Clerk. Regardless of the method of delivery, this form is not deemed filed until it is received by the Chief Clerk, along with the required filing fee.

The mailing address is:

Chief Clerk
NC Utilities Commission
4325 Mail Service Center
Raleigh, NC 27699-4325

Exhibits required by Rule R8-65(g)		Applicant's Response
(1)(i)	Full and correct name of the owner of the facility	OWASA CANE CRK PUMP STATION
	Facility name	CANE CRK PUMP STATION
	Business address	8705 STANFORD RD, CHAPEL HILL, NC 27516
	E-mail address	MTIGER@OWASA.ORG
	Telephone number	(919) 968-4421
(ii)	The owner is (check one)	<input type="checkbox"/> Individual <input type="checkbox"/> Partnership <input checked="" type="checkbox"/> Corporation
	If a partnership, the name and business address of each general partner	
	If a corporation, the state and date of incorporation	NC, June 6, 1975
	If a partnership, the name and address of each general partner (add additional sheets if necessary)	

	Owner's agent for purposes of this report, if applicable:	JOE W. BENNETT, JR.
	Agent's business address	4005 2ND AVENUE SOUTH
	Agent's e-mail address	JBENNETT@EAGLESOLARANDLIGHT.COM
	Agent's telephone number	(205) 202-2208
(iii)	The full and correct name of the site owner and, if the site owner is other than the applicant, the applicant's legal interest in the site	ORANGE WATER AND SEWER AUTHORITY DBA CANE CRK PUMP STATION
(2)(i)	Attach a color map or aerial photo showing the location of the generating facility site in relation to local highways, streets, rivers, streams, and other generally known local landmarks with the proposed location of major equipment indicated on the map or photo, including: the generator, fuel handling equipment, plant distribution system, startup equipment, the site boundary, planned and existing pipelines, planned and existing roads, planned and existing water supplies, and planned and existing electric facilities. A U.S. Geological Survey map or an aerial photo map prepared via the State's geographic information system (found at www.gis.ncdcr.gov/hpweb/) is preferred.	
(ii)	E911 street address of the proposed facility	8705 STANFORD ROAD CHAPEL HILL, NC 27516
	County in which the proposed facility will be physically located	ORANGE
	GPS coordinates of the approximate center of the proposed facility site to the nearest second or one thousandth of a degree	35.939, -79.238
(3)(i)	The nature of the facility, including its technology, and the source of its power and fuel(s)	RENEWABLE ENERGY FACILITY, SOLAR PV, GRID TIED WITH DUKE ENERGY
(ii)	A description of the buildings, structures and equipment comprising the generating facility and the manner of its operation	GROUND-MOUNTED, SOLAR PV ARRAY, GRID TIED WITH DUKE ENERGY
(iii)	The gross and net projected maximum dependable capacity of the facility in megawatts – Alternating Current	0.3 MW (300 kW)

	The facility's nameplate capacity in megawatts – Alternating Current	0.3 MW (300 kW)
(iv)	The projected date on which the facility will come on line	06/01/2020
(v)	The applicant's general plan for sale of the electricity to be generated, including the name of utility to which the applicant plans to sell the electricity	NET METERING, DUKE ENERGY
(vi)	Any provisions for wheeling of the electricity, if applicable	N/A
(vii)	Arrangements for firm, non-firm, or emergency generation, if applicable	N/A
(viii)	The service life of the project	25 YEARS
(ix)	The projected annual sales in kilowatt-hours	N/A
(x)	Whether the applicant intends to produce renewable energy certificates that are eligible for compliance with the State's renewable energy and energy efficiency portfolio standard <input type="checkbox"/> Yes <input checked="" type="checkbox"/> No	
(4)	The expected cost of the proposed facility	\$ LEASED SYSTEM

Confidentiality

If an applicant considers certain of the required information above to be confidential and entitled to protection from public disclosure, it may designate said information as confidential and file it under seal. Documents marked as confidential will be treated pursuant to applicable Commission rules, procedures, and orders dealing with filings made under seal and with nondisclosure agreements.

All reports shall be signed and verified (notarized) by the applicant or by an individual duly authorized to act on behalf of the applicant for the purpose of the report. A blank verification page is attached below:

VERIFICATIONSTATE OF ALABAMA COUNTY OF JEFFERSON

Joe W. Bennett, Jr.
Signature of Owner's Representative or Agent

PRESIDENT, EAGLE SOLAR AND LIGHT LLC
Title of Representative or Agent

JOE W. BENNETT, JR.
Typed or Printed Name of Representative or Agent

The above named person personally appeared before me this day and, being first duly sworn, says that the facts stated in the foregoing report and any exhibits, documents, and statements thereto attached are true as he or she believes.

WITNESS my hand and notarial seal, this 6th day of December, 2019.

My Commission Expires: 01-01-2022

Tyler G. Lewallen
Signature of Notary Public

Tyler G. Lewallen
Name of Notary Public – Typed or Printed

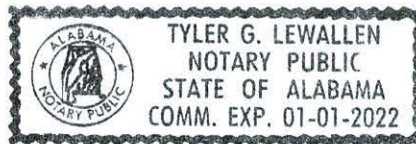

This original verification must be affixed to the original report, and a copy of this verification must be affixed to each of the copies that are also submitted to the Commission.

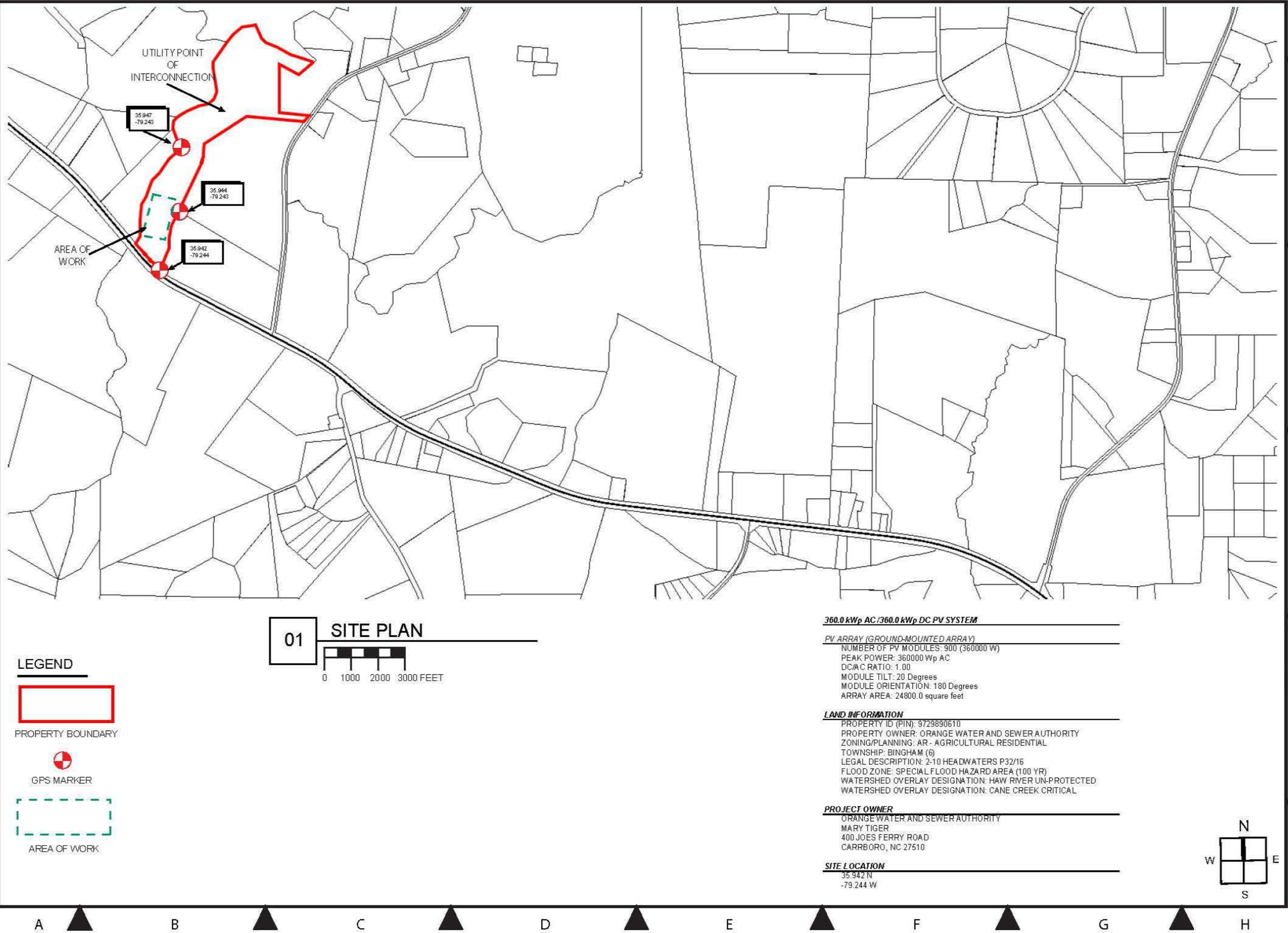

**EAGLE SOLAR
& LIGHT**

Eagle Solar and Light, LLC
4005 2nd Ave South
Birmingham, AL 35222
205-202-2208

www.eaglesolarandlight.com

ALABAMA GENERAL CONTRACTOR
LICENSE NO. 51689
NORTH CAROLINA GEN. CONTRACTOR
LICENSE NO. 79280
GEORGIA GENERAL CONTRACTOR
LICENSE NO. GCQA006143

UNAUTHORIZED USE OF THIS
DRAWING SET WITHOUT WRITTEN
PERMISSION FROM CONTRACTOR
IS IN VIOLATION OF U.S. COPYRIGHT
LAWS AND WILL BE SUBJECT TO
CIVIL DAMAGES AND
PROSECUTIONS.

360.0 KWP DC PV SYSTEM
ORANGE WATER AND
SEWER AUTHORITY
DBA CANE CRK PUMP
STATION
8705 STANFORD ROAD
CHAPEL HILL, NC 27516

DESIGNER OF RECORD



NORTH AMERICAN BOARD OF
CERTIFIED ENERGY PRACTITIONERS
CERT NO. PV102117-016491
JOE W. BENNETT, JR.

PAPER SIZE 11" X 17" (ANSI B)
SITE PLAN

DATE: 12-03-19

DESIGN BY: JOE W BENNETT JR

CHECKED BY: CB

REVISIONS

A-101.00
(SHEET 3)

OFFICIAL COPY

Mar 25 2020